



Toll Free US & Canada: **800-645-8180**

Eastern Division

60 Fleetwood Ct., Ronkonkoma, NY 11779-6907
Telephone: (631) 471-3300 Fax: (631) 471-3308

Western Division

1219 W. Mahalo Place, Rancho Dominguez, CA 90220-5446
Telephone : (310) 632-5400 Fax: (310) 632-3900

Supplying the Aerospace, Defense & Metal Working Industries Since 1951!

Minimum Order

\$100.00 List Price

Terms

Net 30 days on approved credit only.

Approved credit cards.

Prepaid via check or wire transfer.

No C.O.D. shipments.

Returns

Return authorization is required.

Merchandise must be sent freight prepaid to the facility from which it was purchased.

A 20% restocking charge is applicable.

All claims must be made within 7 days of receipt of goods.

Freight

F.O.B. shipping point.

Special Orders

All special orders may require prepayment.

Currency

All prices are in US dollars.

Overseas Customer Terms

Same as above, only **prepayment via bank wire transfer (all fees for buyers account) or by bank check.**

US Air Tool Company (also known as USATCO) has been a family owned and operated business since 1951. We are now a US manufacturer and worldwide distributor of high quality tools for the aviation industry with offices in New York & California. In addition, from the beginning of the homebuilder era in the 1970's, USATCO has been providing tools and equipment to craftsmen around the world who build and fly their own aircraft. These "sheet-metal artists" are now flying thousands of planes built and maintained with USATCO tools.

USATCO offers the highest quality products at competitive prices, with the knowledge and experience necessary for expert advice in product selection. Our courteous staff will be pleased to assist you. And of course, all the products we offer are fully guaranteed. If you don't see what you are looking for, please don't hesitate to contact us. We work hard to provide our customers with straightforward & reliable business. Try us & see!

USATCO.com

Don't forget to check out USATCO Online, with monthly sales, homebuilder specials, surplus items & an easy to use interface its a great place to shop for tools on the web. **www.USATCO.com**

Government IMPAC Cards Accepted

USATCO Tool Repair

We repair all major brand pneumatic tools on our premises. We are an official repair station for Cherry Textron[®], Chicago Pneumatic[®], and Cooper[®] Power Tools (including Dotco[®], Gardener Denver[®], Buckeye[®] and Doler[®]). In addition, we have our own manufacturing and modification facilities. We are riveting and product assembly specialists!

We will be happy to examine your tools free of charge and give you an estimate of repair cost. Ship prepaid to any of our facilities. Please send tensiometers to our New York Lab only.

Please ask about our tool rental policy!

Limited Warranty

If for any reason you are not completely satisfied with any item purchased from us you may request a return authorization within seven (7) days of receipt of goods. When obtained, send us the item (transportation prepaid) for replacement, repair or refund. Tools manufactured by USATCO are warrantied for one (1) year from date of purchase. We cannot assume liability for abuse, misuse or alteration of goods. Any tampering with tools or attempted repairs of same will nullify this warranty. Warranties from other manufacturers available upon request.

USATCO C-Yoke Riveters

Quiet, Easy Operation *CE Approved & Certified*

34-214C



34-720C



- Clamping force exceeds federal specifications.
- New, larger capacity high-force models available below.

Note: 11/16" closed yoke height. Includes swivel air inlet.

Single Cylinder					
Part Number	Reach	Force	Capacity	O.A.L.	Weight
34-214C	1-1/2"	3000 lbs	1/8" Alum. 3/32" Steel	10-5/16" (26 cm)	4.5 lbs (2.1 kgs)
34-214*	N/A	3000 lbs	1/8" Alum. 3/32" Steel	9" (23 cm)	4.0 lbs (1.8 kgs)

NEW High Force Single Cylinder					
Part Number	Reach	Force	Capacity	O.A.L.	Weight
34-214CC	1-1/2"	4200 lbs	5/32" Alum. 1/8" Steel	10-5/16" (26 cm)	4.5 lbs (2.1 kgs)

Tandem Cylinder					
Part Number	Reach	Force	Capacity	O.A.L.	Weight
34-720C	1-1/2"	6000 lbs	3/16" Alum. 5/32" Steel	14" (36 cm)	5.5 lbs (2.5 kgs)
34-720*	N/A	6000 lbs	3/16" Alum. 5/32" Steel	12" (31 cm)	5.0 lbs (2.3 kgs)

NEW High Force Tandem Cylinder					
Part Number	Reach	Force	Capacity	O.A.L.	Weight
34-720CC	1-1/2"	7700 lbs	1/4" Alum. 3/16" Steel	14" (36 cm)	5.5 lbs (2.5 kgs)

* Riveter less yoke. See pages 50-51 for optional USATCO c-yokes.

USATCO 360° Swivel C-Yoke Riveter

Locks In Any Position *CE Approved & Certified*



Note: 11/16" closed yoke height. Includes swivel air inlet.

Single Cylinder					
Part Number	Reach	Force	Capacity	O.A.L.	Weight
34-214SC	1-1/2"	3000 lbs	1/8" Alum. 3/32" Steel	12" (31 cm)	4.5 lbs (2.1 kgs)

Chicago Pneumatic® C-Yoke Riveter



Note: 11/16" closed yoke height. Includes swivel air inlet.

Single Cylinder					
Part Number	Reach	Force	Capacity	O.A.L.	Weight
CP0214CELEL	1-1/2"	3000 lbs	1/8" Alum. 3/32" Steel	10-5/16" (26.2 cm)	4.5 lbs (2.0 kgs)

Tandem Cylinder					
Part Number	Reach	Force	Capacity	O.A.L.	Weight
CP0214FALEL	1-1/2"	6000 lbs	3/16" Alum. 5/32" Steel	14" (35.6 cm)	5.5 lbs (2.5 kgs)

Chicago Pneumatic® C-Yoke Riveters

Includes Safety Throttle Guard



Note: 25/32" closed yoke height.

Single Cylinder					
Part Number	Reach	Force	Capacity	O.A.L.	Weight
CP0351CUDEL	2-1/8"	6000 lbs	3/16" Alum. 5/32" Steel	17-1/2" (45 cm)	12.5 lbs (5.7 kgs)

Tandem Cylinder					
Part Number	Reach	Force	Capacity	O.A.L.	Weight
CP0351FUDEL	2-1/8"	12,000 lbs	1/4" Alum. 7/32" Steel	21-3/4" (55 cm)	15.25 lbs (6.9 kgs)

Chicago Pneumatic® 360° Swivel C-Yoke Riveter

High Force In A Compact Package



- 360° swivel yoke locks in any position.
- Up to 13,500 pounds of force throughout the stroke.

Note: 25/32" closed yoke height.

Single Cylinder					
Part Number	Reach	Force	Capacity	O.A.L.	Weight
CP0341CUDEL	2-1/8"	13,500 lbs	9/32" Alum. 1/4" Steel	17-1/2" (45 cm)	12.5 lbs (5.7 kgs)

RIVET SQUEEZERS & ACCESSORIES

High Power C-Yoke Riveter

NEW

Powerful & Well Balanced



34-820C

More Power Than Our Tandem Series

- Throttle control for precise rivet installation.
- Accepts standard 3/16" tooling.
- Full squeeze force at only 90 PSI.

Made In The USA

Note: 11/16" closed yoke height. Includes swivel air inlet.

Tri-Cylinder					
Part Number	Reach	Force	Capacity	O.A.L.	Weight
34-820C	1-1/2"	9000 lbs	1/4" Alum. 3/16" Steel	18-3/4" (47.6 cm)	8.5 lbs (3.9 kgs)

Ultralite® C-Yoke Riveters

Lightweight & Ergonomic Design



- 50% weight reduction over similar models.
- High-strength forged jaws, precision bearings & shafts.

Note: Stroke at maximum force is 1/8".

Tri-Cylinder					
Part No.	Reach	Force	Capacity	O.A.L.	Weight
16357	Varies (see below)	11,000 lbs	5/16" Alum. 1/4" Steel	21" (53 cm)	10.1 lbs (4.6 kgs)

Note: To order combine riveter part number (above) & desired yoke number (below).
Example: For 2" reach, 1-1/2" gap (3/16" set hole), part number would be **16357-7481**.

C-Yokes - 3/16" Set Hole				C-Yokes - 1/4" Set Hole			
Suffix	Reach	Gap	Thick.	Suffix	Reach	Gap	Thick.
7479	1-1/2"	1-1/4"	3/4"	3052	1-1/2"	1-1/4"	3/4"
7481	2"	1-1/2"	7/8"	6477	2"	1-1/2"	7/8"
7482	3"	1-1/2"	1-1/8"	6478	3"	1-1/2"	1-1/8"
7483	1-1/2"	2"	1"	6479	1-1/2"	2"	1"
7484	2-1/2"	1-3/8"	1"	6480	2-1/2"	1-3/8"	1"
7485	2-1/2"	1-3/4"	1-1/8"	6481	2-1/2"	1-3/4"	1-1/8"



For Rivet Gauges & Rivet Cutters See Pages 39-40

USATCO Alligator Yoke Riveters

CE Approved & Certified



34-214A-2-1/4



34-725A-1-1/2

Quiet, Easy Operation

- Clamping force exceeds federal specifications.
- New, larger capacity high-force models available below.

Note: 7/8" closed yoke height. Includes swivel air inlet.

Single Cylinder					
Part Number	Reach	Force	Capacity	O.A.L.	Weight
34-214A-1-1/2	1-1/2"	3000 lbs	1/8" Alum. 3/32" Steel	9-3/16" (23 cm)	3.75 lbs (1.7 kgs)
34-214A-2-1/4	2-1/4"	2200 lbs	1/8" Alum. 3/32" Steel	10" (25 cm)	4.25 lbs (1.9 kgs)
34-214A-3	3"	1800 lbs	3/32" Alum. 1/16" Steel	10-3/4" (27 cm)	4.50 lbs (2.1 kgs)

NEW High Force Single Cylinder					
Part Number	Reach	Force	Capacity	O.A.L.	Weight
34-214AA-1-1/2	1-1/2"	4300 lbs	5/32" Alum. 1/8" Steel	9-3/16" (23 cm)	3.75 lbs (1.7 kgs)
34-214AA-2-1/4	2-1/4"	3900 lbs	1/8" Alum.	10" (25 cm)	4.25 lbs (1.9 kgs)
34-214AA-3	3"	3400 lbs	3/32" Alum.	10-3/4" (27 cm)	4.50 lbs (2.1 kgs)

Tandem Cylinder					
Part Number	Reach	Force	Capacity	O.A.L.	Weight
34-725A-1-1/2	1-1/2"	6000 lbs	3/16" Alum. 5/32" Steel	11-3/16" (28 cm)	4.75 lbs (2.2 kgs)
34-725A-2-1/4	2-1/4"	4300 lbs	5/32" Alum. 1/8" Steel	12-3/4" (32 cm)	5.25 lbs (2.4 kgs)
34-725A-3	3"	3400 lbs	1/8" Alum. 3/32" Steel	13-1/2" (34 cm)	5.50 lbs (2.5 kgs)

NEW High Force Tandem Cylinder					
Part Number	Reach	Force	Capacity	O.A.L.	Weight
34-725AA-1-1/2	1-1/2"	7500 lbs	1/4" Alum. 3/16" Steel	11-3/16" (28 cm)	4.75 lbs (2.2 kgs)
34-725AA-2-1/4	2-1/4"	6300 lbs	3/16" Alum. 5/32" Steel	12-3/4" (32 cm)	5.25 lbs (2.4 kgs)
34-725AA-3	3"	5600 lbs	3/16" Alum. 1/8" Steel	13-1/2" (34 cm)	5.50 lbs (2.5 kgs)

Chicago Pneumatic® Alligator Yoke Riveters



Note: 7/8" closed yoke height. Includes swivel air inlet.

Single Cylinder					
Part Number	Reach	Force	Capacity	O.A.L.	Weight
CP0214ANBEL	1-1/2"	3000 lbs	1/8" Alum. 3/32" Steel	9-3/16" (23 cm)	3.75 lbs (1.7 kgs)
CP0214ANFEL	2-1/4"	2200 lbs	1/8" Alum. 3/32" Steel	10" (25 cm)	4.25 lbs (1.9 kgs)
CP0214ANGEL	3"	1800 lbs	3/32" Alum. 1/16" Steel	10-3/4" (27 cm)	4.50 lbs (2.0 kgs)

Tandem Cylinder					
Part Number	Reach	Force	Capacity	O.A.L.	Weight
CP0214ENBEL	1-1/2"	6000 lbs	3/16" Alum. 5/32" Steel	11-3/16" (28 cm)	4.75 lbs (2.2 kgs)
CP0214ENFEL	2-1/4"	4300 lbs	5/32" Alum. 1/8" Steel	12-3/4" (32 cm)	5.25 lbs (2.4 kgs)
CP0214ENGEL	3"	3400 lbs	1/8" Alum. 3/32" Steel	13-1/2" (34 cm)	5.50 lbs (2.5 kgs)

CP® Heavy-Duty Alligator Yoke Riveters

Includes Safety Throttle Guard



Closed Yoke Heights: -SGEL & -SKEL, 7/8"; -SREL, 1-1/2"; -SVEL, 3/4".

Single Cylinder					
Part Number	Reach	Force	Capacity	O.A.L.	Weight
CP0351ASGEL	2-7/8"	5200 lbs	5/32" Alum. 1/8" Steel	19-1/2" (50 cm)	15.75 lbs (7.1 kgs)
CP0351ASKEL	5"	3400 lbs	1/8" Alum. 3/32" Steel	21-5/8" (55 cm)	19.75 lbs (9.0 kgs)
CP0351ASREL	7"	3000 lbs	1/8" Alum. 3/32" Steel	23-5/8" (60 cm)	24.25 lbs (11.0 kgs)
CP0351ASVEL	9-1/8"	3000 lbs	1/8" Alum. 3/32" Steel	25-3/4" (65 cm)	26.25 lbs (11.9 kgs)

Tandem Cylinder					
Part Number	Reach	Force	Capacity	O.A.L.	Weight
CP0351ESGEL	2-7/8"	10,400 lbs	1/4" Alum. 3/16" Steel	23-3/4" (60 cm)	18.5 lbs (8.4 kgs)
CP0351ESKEL	5"	6800 lbs	3/16" Alum. 5/32" Steel	25-7/8" (66 cm)	22.5 lbs (10.2 kgs)
CP0351ESREL	7"	6000 lbs	3/16" Alum. 5/32" Steel	27-7/8" (71 cm)	27.0 lbs (12.3 kgs)
CP0351ESVEL	9-1/8"	6000 lbs	3/16" Alum. 5/32" Steel	30" (76 cm)	29.0 lbs (13.2 kgs)

Ultralite® Alligator Yoke Riveters

Ergonomic Design



- 50% weight reduction over similar models.
- High-strength forged jaws, precision bearings & shafts.

Tri-Cylinder					
Part No.	Reach	Force	Capacity	O.A.L.	Weight
17283	3"	10,000 lbs	1/4" Alum. 3/16" Steel	20-1/4" (50 cm)	8.4 lbs (3.8 kgs)
	5"	6800 lbs	3/16" Alum. 5/32" Steel	22-1/2" (55 cm)	9.5 lbs (4.3 kgs)

Note: To order combine riveter part number (above) & desired yoke number (below). Example: For 5" reach (1/4" set hole) riveter, part number would be 17283-17147.

Alligator Yokes - 3/16" Set Hole		
Suffix	Reach	Travel
17148	3"	7/8"
17146	5"	1-1/4"

Alligator Yokes - 1/4" Set Hole		
Suffix	Reach	Travel
17149	3"	7/8"
17147	5"	1-1/4"

High Power Alligator Yoke Riveters

NEW

Powerful & Well Balanced



Made In The USA



More Power Than Our Tandem Series

- Throttle control for precise rivet installation.
- Accepts standard 3/16" tooling.
- Full squeeze force at only 90 PSI.

Note: 7/8" closed yoke height. Includes swivel air inlet.

Tri-Cylinder					
Part Number	Reach	Force	Capacity	O.A.L.	Weight
34-825A-1-1/2	1-1/2"	9000 lbs	1/4" Alum. 3/16" Steel	16" (40.6 cm)	7 lbs (3.2 kgs)
34-825A-2-1/4	2-1/4"	7000 lbs	3/16" Alum. 5/32" Steel	16-3/4" (42.5 cm)	7.5 lbs (3.4 kgs)
34-825A-3	3"	5200 lbs	3/16" Alum. 5/32" Steel	17-1/2" (44.4 cm)	8 lbs (3.6 kgs)

RIVET SQUEEZERS & ACCESSORIES

USATCO Deep Reach Alligator Yoke Riveter

CE Approved & Certified



Extra Long 12" Reach

Note: 1" closed yoke height.

Tandem Cylinder					
Part Number	Reach	Force	Capacity	O.A.L.	Weight
34-351TA-12	12"	3000 lbs	1/8" Alum. 3/32" Steel	32-7/8" (84 cm)	39 lbs (17.7 kgs)

USATCO Rebuilt Portable Rivet Squeezers

Save Up To 50% Off Current New Prices



39-214C

- USATCO has been reconditioning all types of tools since 1951.
- All riveters that go through our shop look & operate like new.
- USATCO maintains a large inventory of riveters too varied to list here, please inquire.

Note: 11/16" closed yoke height.

C-Yoke Single Cylinder				
Part Number	Reach	Capacity	O.A.L.	Weight
39-214C	1-1/2"	1/8" Alum. 3/32" Steel	10-5/16" (26 cm)	4.5 lbs (2.0 kgs)

Note: 25/32" closed yoke height.

C-Yoke Tandem Cylinder				
Part Number	Reach	Capacity	O.A.L.	Weight
39-351TC	2-1/8"	1/4" Alum. 7/32" Steel	21-3/4" (55 cm)	15.25 lbs (6.9 kgs)

Note: 7/8" closed yoke height, except 39-351A-7 (1-1/2") & 39-351A-9-1/8 (3/4").

Alligator Yoke Single Cylinder				
Part Number	Reach	Capacity	O.A.L.	Weight
39-214A1-1/2	1-1/2"	1/8" Alum. 3/32" Steel	9-3/16" (23 cm)	3.75 lbs (1.7 kgs)
39-214A-2-1/4	2-1/4"	1/8" Alum. 3/32" Steel	10" (25 cm)	4.25 lbs (1.9 kgs)
39-214A-3	3"	3/32" Alum. 1/16" Steel	10-3/4" (27 cm)	4.50 lbs (2.0 kgs)
39-351A-2-7/8	2-7/8"	5/32" Alum. 1/8" Steel	19-1/2" (50 cm)	15.75 lbs (7.1 kgs)
39-351A-5	5"	1/8" Alum. 3/32" Steel	21-5/8" (54 cm)	19.75 lbs (9.0 kgs)
39-351A-7	7"	1/8" Alum. 3/32" Steel	23-5/8" (65 cm)	24.25 lbs (11.0 kgs)
39-351A-9-1/8	9-1/8"	1/8" Alum. 3/32" Steel	25-3/4" (65 cm)	26.25 lbs (11.9 kgs)

USATCO Rebuilt Portable Rivet Squeezers (cont'd)

Note: 7/8" closed yoke height, except 39-351TA-7 (1-1/2") & 39-351TA-9-1/8 (3/4").

Alligator Yoke Tandem Cylinder				
Part Number	Reach	Capacity	O.A.L.	Weight
39-351TA-2-7/8	2-7/8"	1/4" Alum. 3/16" Steel	23-3/4" (60 cm)	18.5 lbs (8.4 kgs)
39-351TA-5	5"	3/16" Alum. 5/32" Steel	25-7/8" (66 cm)	22.5 lbs (10.2 kgs)
39-351TA-7	7"	3/16" Alum. 5/32" Steel	27-7/8" (71 cm)	27.0 lbs (12.3 kgs)
39-351TA-9-1/8	9-1/8"	3/16" Alum. 5/32" Steel	30" (76 cm)	29.0 lbs (13.2 kgs)



39-351AO-2-7/8

Note: 7/8" closed yoke height.

Offset Alligator Yoke Single Cylinder*				
Part Number	Reach	Capacity	O.A.L.	Weight
39-351AO-2-7/8	2-7/8"	5/32" Alum. 1/8" Steel	19-1/2" (50 cm)	15.75 lbs (7.1 kgs)
39-351AO-5	5"	5/32" Alum. 1/8" Steel	21-5/8" (55 cm)	19.75 lbs (9.0 kgs)
39-351AO-7	7"	1/8" Alum. 3/32" Steel	23-5/8" (60 cm)	24.25 lbs (11.0 kgs)

* We can offer these units with a pre-installed Power Boost Assembly (below) for added compression power, please inquire.

Power Booster Assembly



Part Number	For Use With
38-351B	CP0351 Type Riveters

Throttle Guard Kit



Easy To Install

Includes Replacement Pin & Gasket

Convert your older riveter to today's safety standards.

Part Number	For Use With
90793	CP0351 Type Riveters

Selecting Rivet Sets For Your Compression Riveters

To develop maximum power, the riveter must drive the rivet near the end of the riveter's stroke. Therefore, the combined length of the two rivet sets must be correct. **Determine the correct length as follows:**

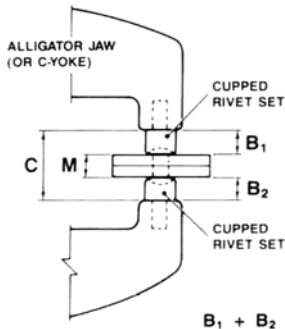

When two cupped rivet sets are used:

The length of the body dimensions of the two rivet sets (B_1 , B_2) should equal the closed height dimension of the yoke (C) minus the total thickness of material being riveted (M).

$B_1 + B_2 = C - M$

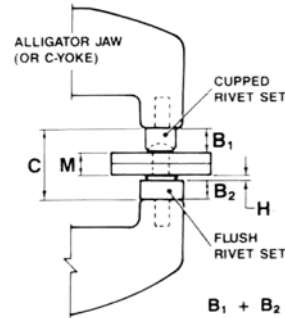

When one cupped & one flush set are used:

The length of the body dimensions of the two rivet sets (B_1 , B_2) should equal the closed height dimension of the yoke (C) minus the total thickness of material being riveted (M) and the height of the finished rivet head driven by the flush set (H).

$B_1 + B_2 = C - M - H$

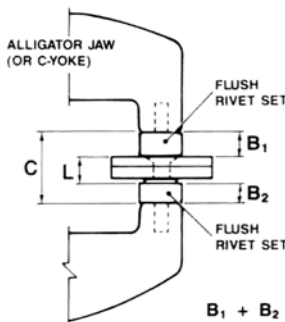

When two flush sets are used:

The length of the body dimensions of the two rivet sets (B_1 , B_2) should equal the closed height dimension of the yoke (C) minus the overall length of the rivet after it is driven (L).

$B_1 + B_2 = C - L$

The closed height dimension of the yoke referred to is the opening available when the jaws or plunger are in extreme closed or forward position with both rivet sets removed.

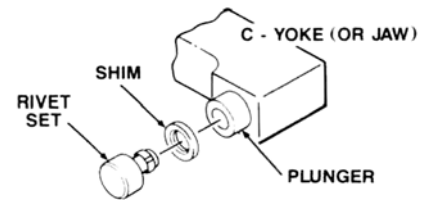

If necessary, select rivet sets a little short and shim to proper length with hardened shims (1/64", 1/32", 1/16" or 1/8" thick).

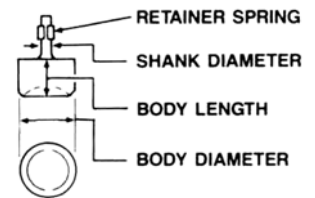

Head or die configuration: Cupped or flush; available in button, round, brazier, universal or flat head configurations.

A Wide Selection Of Squeezer Sets Are Offered On Pages 53-56

Adjustable Set Holder

NEW

Fast & Easy Adjustments



- Replaces the rigid 2-9/16" set holder standard to most CP214 style single cylinder pneumatic squeezers.
- Eliminates the need to shim the dies and sets with washers.
- Heat treated 4130 steel investment casing with rolled threads.

Note: Not for use with tandem cylinder squeezers.

Part Number	Description
97798	Adj. Set Holder

Foot Control Attachments



Convert Your Riveter To Hands-Free Foot Operation

351 Type Foot Control (shown)

- Includes foot control with 6' cable (riveter sold separately).

Part Number	For Use With
15-2C	CP0351 Type Riveters

214 Type Foot Control

- Includes foot throttle backhead & 7.5' hose (riveter sold separately).

Part Number	For Use With
15-214FC	214 Type Riveters

RIVET SQUEEZERS & ACCESSORIES

USATCO Rivet Squeezer Floor Stands

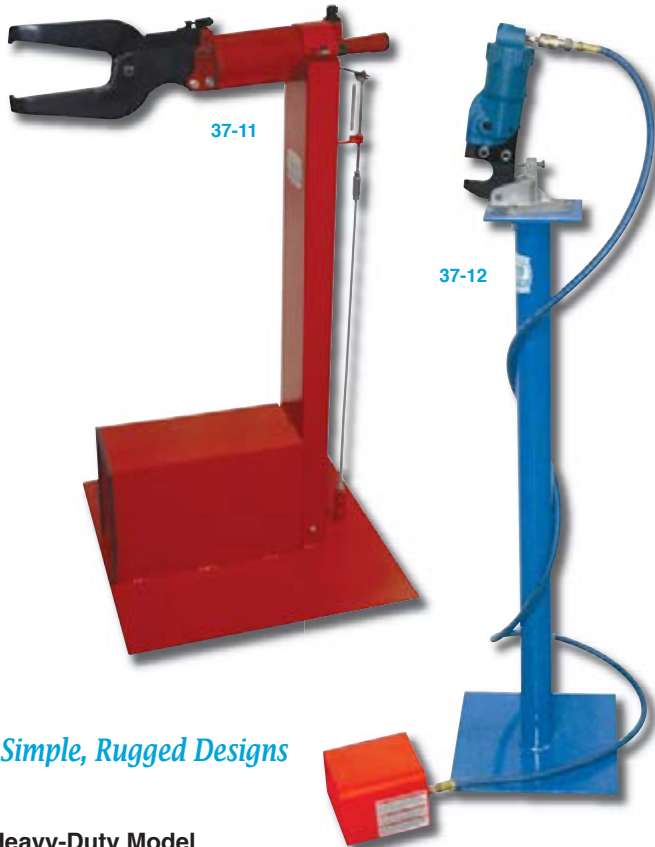

Simple, Rugged Designs

Heavy-Duty Model

- Fits alligator yoke CP0351A & APT riveter series.
- Manufactured by USATCO for major aircraft companies.

Part No.	Includes	Height
37-11	Stand & Foot Control	45" (114 cm)

Lightweight Models

- Fits most c-yoke 214 riveter series.
- USATCO original design.
- Adaptations to suit customer requirements, please inquire.

Part No.	Includes	Height
37-12	Stand, Foot Control & Conversion Head	40" (102 cm)
37-13	Bench Mount, Foot Control & Conv. Head	

Note: When ordering please specify make & model number of riveter to be mounted. Riveters shown not included.

2 PC Quick-Change Yoke Pin Set

NEW



Change Yokes Fast

Pull rings allow user to swap out yokes quickly & easily.

Note: For use with 214 type pneumatic squeezers.

Part Number	Pin Diameter	Pin Length
96396	1/4" (6.4 mm)	3/4" (19 mm)

USATCO Rivet Squeezer Stand For Ultralite® Riveters

NEW

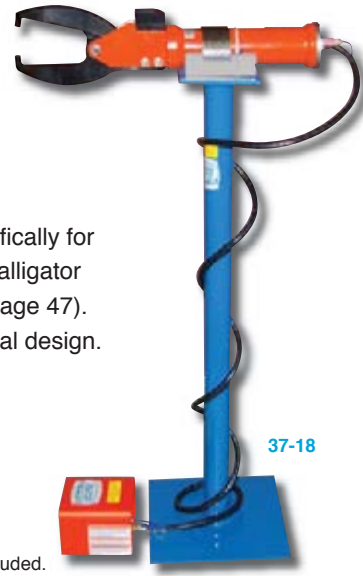

- Designed specifically for Ultralite 17283 alligator yoke riveters (page 47).
- USATCO original design.

Note: Riveter shown not included.

Part No.	Includes	Height
37-18	Stand & Hands Free Foot Control	40" (102 cm)
37-20	Hands Free Foot Control Only (portable)	—

USATCO Longeron C-Yoke

Excellent Maneuverability

- With 3/4" extra clearance.
- Precision crafted & heat treated.
- Takes standard .187" shank rivet sets.



1-5/16" Mount Spacing		
Part Number	Reach	Gap
64-7755	2-1/2"	1-1/4"

USATCO 360° Swivel C-Yokes



Locks In Any Position

- Adjustable tool holder eliminates the need for shimming.
- Takes standard .187" shank rivet sets.

1-5/16" Mount Spacing			
Part Number	Reach	Gap	For Use With
64-C360-1	1-1/2"	1-1/4"	USATCO 214C Series, CP0214CENEL
64-C360-3	3"	1-1/4"	

USATCO C-Yokes For Semi-Tubular Rivets



- Designed especially for semi-tubular rivets to 5/16".
- Takes standard .187" shank rivet sets.

Note: Yokes require set holder.

Set Holder	
Part No.	For Use With
38-539	64-C28 to 64-C39

Yoke: 1-5/16" Mount Spacing		
Part Number	Reach	Gap
64-C28	1-1/8"	1-3/4"
64-C29	1-1/8"	2"
64-C30	1-1/8"	2-1/4"
64-C31	1-1/8"	2-1/2"
64-C32	1-1/8"	2-3/4"
64-C33	1-1/8"	3"
64-C34	1-1/8"	3-1/2"
64-C35	1-1/8"	4"
64-C36	1-1/8"	4-7/16"
64-C37	1-1/8"	3-1/4"
64-C38	1-1/8"	3-3/4"
64-C39	1-1/8"	4-1/4"

USATCO Alligator Jaw Assemblies



Made In The USA

64-A5-2

- Precision crafted & heat-treated, all hardware included.
- The same yokes as installed on our 34-214A & 34-725A riveters.
- Will also fit CP & other similar tools.

Part No.	Reach	Gap
64-A5-1	1-1/2"	0.89"
64-A5-2	2-1/4"	0.89"
64-A5-3	3"	0.89"

USATCO C-Yokes

- All yokes come with .187" set holes, but can be furnished with .250" set holes (please inquire).
- Set holders may be required, see charts below.

USATCO Can Fabricate Your Custom Yoke Designs, Please Inquire

Yoke: 1-5/16" Mount Spacing		
Part No.	Reach	Gap
64-C1	1-7/16"	1-1/4"
64-C4	3-1/2"	1-3/4"
64-C5	4-1/8"	2-1/2"
64-C8	4-1/2"	3-1/2"
64-C9	10"	3-1/2"
64-C16	2"	2"
64-C200	2"	1-1/4"
64-C300	3"	1-1/4"
64-959	2-1/2"	1-3/8"
64-960HD	3"	1-1/2"
64-961HD	3-1/2"	1-1/2"

Note: 64-C8, 64-C9 & 64-C16 yokes include adjustable threaded adapter.

Yoke: 1-5/8" Mount Spacing		
Part No.	Reach	Gap
64-C3	4-7/16"	1-5/8"
64-C6	20-1/2"	2-1/4"
64-C7	1-1/2"	1-1/4"
64-C10	2-1/8"	1-1/8"

Yoke: 2-1/16" Mount Spacing		
Part No.	Reach	Gap
64-C11	2-1/8"	1-1/8"



1-5/16" Mount Spacing Yokes: Will fit all 214 type riveters, USATCO 34-214C & 34-720C. Requires set holder, see below.
1-5/8" Mount Spacing Yokes: Will fit CP0351C & CP0351CUNEL (for CP#1 yoke frames).
2-1/16" Mount Spacing Yokes: Will fit CP0351CUNEL (for CP#2 yoke frames).

Set Holders	
Part Number	For Use With
38-539	64-C1, 64-C200 & 64-959
38-539-2	64-C16
38-539-2A	64-C4 & 64-C300

Set Holders	
Part Number	For Use With
38-539-3	64-C8, 64-960HD & 64-961HD
38-539-4	64-C5
38-539-6	64-C9

RIVET SQUEEZERS & ACCESSORIES

Stainless Steel Hand Rivet Squeezers

Adjustable Ram

10-THS10



- Stainless steel construction designed for lasting performance.
 - Takes standard .187" shank rivet sets.
 - Heat-treated on all wear & deflecting components.
- NEW Stainless Steel Squeezer Kit:**
- Includes tool, 3 univ. AN470 (3/32", 1/8" & 5/32") & 2 flush sets.

Rugged & Portable

1/16" to 5/32" Capacity (aluminum)			
Tool Only	Squeezer Kit	Reach	Gap
10-THS10	53-THS10	1"	1-1/4"
10-THS20	53-THS20	2"	1-1/4"
10-THS22	53-THS22	2"	2"
10-THS30	53-THS30	3"	1-1/4"
10-THS40	53-THS40	4"	1-1/4"
10-THS50	53-THS50	5"	1-1/4"
10-THS60	53-THS60	6"	1-1/4"

Replacement Yokes		
Part No.	Reach	Gap
THY10	1"	1-1/4"
THY101	1"	1" Flush
THY15	1-1/2"	1-1/4"
THY20	2"	1-1/4"
THY22	2"	2"
THY25	2-7/8"	1-1/4"

Replacement Yokes		
Part No.	Reach	Gap
THY30	3"	1-1/4"
THY35	3-1/2"	1-1/4"
THY40	4"	1-1/4"
THY50	5"	1-1/4"
THY60	6"	1-1/4"

Note: Narrow nose available, please inq.

3 PC Quick-Change Yoke Pin Sets

Change Yokes Fast



Pull rings allow user to swap out yokes quickly & easily.

For Texas & Tatco (THS) Style Hand Squeezers (above)

Part Number	Description
96394	3 PC Yoke Pin Set

For USATCO (420) Style Hand Squeezers (next page)

Part Number	Description
96398	3 PC Yoke Pin Set

360° Swivel Hand Rivet Squeezers

Adjustable Ram

10-502AH-D



- Full 360° yoke can be locked in any position.
 - Takes standard .187" shank rivet sets.
 - Tool has a 3/8" stroke & 5/8" ram adjustment (no washers needed).
- NEW Swivel Squeezer Kit:**
- Includes tool, 3 univ. AN470 (3/32", 1/8" & 5/32") & 2 flush sets.

5/32" Capacity (aluminum)			
Tool Only	Squeezer Kit	Reach	Gap
10-502AH-D	53-502AH-D	1-1/2"	1-1/4"
10-502AH-E	53-502AH-E	3"	1-1/4"

DA Series 360° Swivel Hand Rivet Squeezers

3500 Pounds Of Squeezing Pressure

10-DA-5



Adjustable Ram

- Full 360° yoke can be locked in any position.
- Uses squeezer sets or 3/8"-24 adapter dollie (below).

NEW DA Series Squeezer Kit:

- Includes hand rivet squeezer, three universal AN470 sets (3/32", 1/8" & 5/32"), two flush sets & two adapter dollies.

5/32" Capacity (aluminum)			
Tool Only	Squeezer Kit	Reach	Gap
10-DA-2	53-DA-2	2-1/2"	1-5/8"
10-DA-5	53-DA-5	6"	1-5/8"

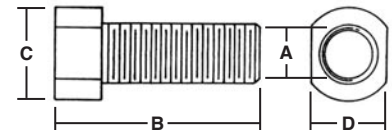

Adapter Dollie:

- Enables use of any of our .187" shank riveting or dimpling sets.
- 3/8"-24 thread size, includes lock nut.

Part No.	'A' Dim	'B' Dim	'C' Dim	'D' Dim
27-5-4	.187"	1"	1/2"	7/16"

USATCO Hand Rivet Squeezers

Adjustable Set Holder



- Takes standard .187" shank rivet sets. **53-420-1A**
- Includes 3 universal AN470 (3/32", 1/8" & 5/32") & 2 flush sets.

Tool With Single Yoke - 1/16" to 5/32" Capacity (aluminum)		
Part Number	Reach	Gap
53-420-1A	1"	1-1/4"
53-420-2A	2"	1-1/4"
53-420-3A	3"	1-1/4"

Note: Dimpling capacity is 1/16" to 3/16" in material up to 0.040".

Tool With Extra Yokes	
Part Number	Yokes Included
53-420-12A	1" & 2"
53-420-13A	1" & 3"
53-420-23A	2" & 3"
53-420-123A	1", 2" & 3"

Power Hand Rivet Squeezer

Our Most Powerful Model



10-501A

- Deep throat with ample leverage & heat-treated tool steel jaws.
- Takes standard .187" shank rivet sets.

NEW Power Hand Squeezer Kit:

- Includes power hand rivet squeezer, four universal AN470 sets (3/32", 1/8", 5/32" & 3/16") & two flush sets.

3/16" Capacity (aluminum)			
Tool Only	Squeezer Kit	Reach	Gap
10-501A	53-501A	2-1/2"	1-1/8"



For Clecos & Cleco Installation Tools See Page 149

Cupped Squeezer Sets

Made In The USA



- High alloy steel construction.
- Precision ground shanks.
- Faces polished to high luster.
- Heat-treated for long wear & tool life.

.187" Shank, 3/8" Dia.		.187" Shank, 1/2" Dia.		.250" Shank, 5/8" Dia.		.312" Shank, 5/8" Dia.		.375" Shank, 5/8" Dia.	
Part No.	Body L	Part No.	Body L	Part No.	Body L	Part No.	Body L	Part No.	Body L
—	1/8"	26-010	1/8"	—	1/8"	—	1/8"	—	1/8"
26-100	1/4"	26-200	1/4"	26-220	1/4"	26-240	1/4"	26-260	1/4"
26-101	3/8"	26-201	3/8"	26-221	3/8"	26-241	3/8"	26-261	3/8"
26-102	1/2"	26-202	1/2"	26-222	1/2"	26-242	1/2"	26-262	1/2"
26-103	5/8"	26-203	5/8"	26-223	5/8"	26-243	5/8"	26-263	5/8"
26-104	3/4"	26-204	3/4"	26-224	3/4"	26-244	3/4"	26-264	3/4"

Note: Select a set (charts above) & add the desired cupping (chart below). Example: For a .187" shank, 1/2" dia., 1/4" body length set with a 1/8" AN470 cupping, use part no. 26-200-470A.

Cupping Size	Round AN430	Button AN435	Flat AN442	Brazier AN455	Mod. Brazier AN456	Universal AN470
1/16"	4302	4352	4422	4552	4562	4702
3/32"	4303	4353	4423	4553	4563	4703
1/8"	4304	4354	4424	4554	4564	4704
5/32"	4305	4355	4425	4555	4565	4705
3/16"	4306	4356	4426	4556	4566	4706
7/32"	4307	4357	4427	4557	4567	4707
1/4"	4308	4358	4428	4558	4568	4708
5/16"	43010	43510	44210	45510	45610	47010
3/8"	43012	43512	44212	45512	45612	47012

RIVET SQUEEZERS & ACCESSORIES

Squeezer Sets For AN450 Tubular Rivets



.187" Shank	.250" Shank	.312" Shank	.375" Shank	Body Length
26-200	26-220	26-240	26-260	1/4"
26-201	26-221	26-241	26-261	3/8"
26-202	26-222	26-242	26-262	1/2"
26-203	26-223	26-243	26-263	5/8"
26-204	26-224	26-244	26-264	3/4"

Note: Select a set (chart above), add rivet size & type (chart below). **Example:** For a .187" shank, 1/4" body length set with a 1/8" rivet size (flaring), use part no. 26-200-4502.

Semi-Tubular AN450 Cupping Sizes							
Size	1/16"	3/32"	1/8"	5/32"	3/16"	1/4"	5/16"
Flaring	4502	4503	4504	4505	4506	4508	45010
Anvil	2	3	4	5	6	8	10

Cupped Squeezer Sets For BOEING® BACR15FT Type



.187" Shank	.250" Shank	Body Length
26-200	26-220	1/4"
26-201	26-221	3/8"
26-202	26-222	1/2"
26-203	26-223	5/8"
26-204	26-224	3/4"

Note: Select the size set required (charts above), then add the desired cupping (chart below). **Example:** For a .187" shank, 1/4" body length set with a 1/8" BACR15FT cupping, use part number 26-200-4704BAC.

Modified Universal AN470 Cupping Sizes			
3/32"	1/8"	5/32"	3/16"
4703BAC	4704BAC	4705BAC	4706BAC
7/32"	1/4"	9/32"	
4707BAC	4708BAC	4709BAC	

Soft Blank Sets

- Not heat-treated, easily machinable.
- Retainer spring provided.



.187" Shank		.187" Shank	
Part Number	Body Length	Part Number	Body Length
26-211B	1/4"	26-215B	3/4"
26-212B	3/8"	26-216B	7/8"
26-213B	1/2"	26-217B	1"
26-214B	5/8"		

Flush Squeezer Sets



.187" Shank, 3/8" Dia.		.187" Shank, 1/2" Dia.	
Part Number	Body Length	Part Number	Body Length
26-110	1/8"	26-210	1/8"
26-110A	3/16"	26-210A	3/16"
26-111	1/4"	26-211	1/4"
26-112	3/8"	26-212	3/8"
26-113	1/2"	26-213	1/2"
26-114	5/8"	26-214	5/8"
26-115	3/4"	26-215	3/4"
26-116	7/8"	26-216	7/8"
26-117	1"	26-217	1"

.250" Shank, 5/8" Dia.		.312" Shank, 5/8" Dia.	
Part Number	Body Length	Part Number	Body Length
26-230	1/8"	26-250	1/8"
26-230A	3/16"	26-250A	3/16"
26-231	1/4"	26-251	1/4"
26-232	3/8"	26-252	3/8"
26-233	1/2"	26-253	1/2"
26-234	5/8"	26-254	5/8"
26-235	3/4"	26-255	3/4"
26-236	7/8"	26-256	7/8"
26-237	1"	26-257	1"

.375" Shank, 3/4" Dia.		.375" Shank, 3/4" Dia.	
Part Number	Body Length	Part Number	Body Length
26-270	1/8"	26-274	5/8"
26-270A	3/16"	26-275	3/4"
26-271	1/4"	26-276	7/8"
26-272	3/8"	26-277	1"
26-273	1/2"		

Sleeved & Spring Loaded Flush Squeezer Sets

Spring tension holds workpiece steady during rivet installation.



.187" Shank			.250" Shank		
Part No.	I.D.	O.D.	Part No.	I.D.	O.D.
26-1043	3/8"	9/16"	26-1044	3/8"	9/16"
26-1045	19/64"	1/2"	26-1046	19/64"	1/2"

Shank Adapters

Part Number	Body Length	Shank	Accepts
26-1	3/8"	.250"	.187"
26-2	3/8"	.312"	.187"



Includes retainer spring.

Spacer Shims

Used for proper adjustment of squeezer set height to accommodate different material thickness.



Hard Steel

.187" Shank		.250" Shank		.312" Shank	
Part No.	Thickness	Part No.	Thickness	Part No.	Thickness
27-0	1/64"	27-3	1/32"	27-6	1/32"
27-1	1/32"	27-4	1/16"	27-7	1/16"
27-2	1/16"	27-5	1/8"	27-8	1/8"

Huck & Hi-Shear Squeezer Sets



HS 26-200-4



H 26-205-8

Hi-Shear .187" Shank	
Part Number	Rivet Size
HS 26-200-4	1/8"
HS 26-200-5	5/32"
HS 26-200-6	3/16"
HS 26-200-8	1/4"

Huck Lockbolt .187" Shank	
Part Number	Rivet Size
H 26-205-4	1/8"
H 26-205-5	5/32"
H 26-205-6	3/16"
H 26-205-8	1/4"
H 26-205-10	5/16"

Hi-Shear .250" Shank	
Part Number	Rivet Size
HS 26-220-4	1/8"
HS 26-220-5	5/32"
HS 26-220-6	3/16"
HS 26-220-8	1/4"
HS 26-220-10	5/16"
HS 26-220-12	3/8"

Huck Lockbolt .250" Shank	
Part Number	Rivet Size
—	1/8"
H 26-225-5	5/32"
H 26-225-6	3/16"
H 26-225-8	1/4"
H 26-225-10	5/16"
H 26-225-12	3/8"

Adapto® Hand Flaring Kit



53-100-1

Ideal For Prototype & Small Runs

Now Includes Riveting Block

- Easy to use, specially designed for semi-tubular rivets.
- Complete kit includes tool with flaring & oval sets for 1/16" to 3/32", 1/8" to 5/32" & 3/16" rivets, riveting block & plastic case.

Part Number	Description
53-100-1	Complete 13 PC Kit
08-100	Flaring Tool Only

Rivet Squeezer Set Kits



53-26

Set Assortment Kit Includes:

4 Universal AN470 Sets (1/8" body length: 3/32", 1/8", 5/32" & 3/16"), 6 Universal AN470 Sets (1/4" body length: 1/16", 3/32", 1/8", 5/32", 3/16" & 1/4"), 4 Round AN430 Sets (1/16", 3/32", 1/8" & 5/32"), 1 Flat AN442 Set (1/4" body length: 3/32"), 4 Flush Sets with 3/8" Diameter (1 each: 1/8", 1/4", 3/8" & 1/2" body length), 4 Flush Sets with 1/2" Diameter (1 each: 1/8", 1/4", 3/8" & 1/2" body length), Soft Blank Set (1/4" body length), Shim Post Holder, 6 Spacer Shims (2 each: 1/64", 1/32" & 1/16"), Metal Kit Box

Part Number	Description
53-26	31 PC Set Assortment Kit



53-26F

Flush Set Kit Includes:

8 Flush Sets with 3/8" Diameter (2 each: 1/8", 1/4", 3/8" & 1/2" body length), 12 Flush Sets with 1/2" Diameter (1 each: 1/8", 3/16", 1/4", 3/8", 1/2" & 5/8" body length), 3 Soft Blank Sets (1 each: 1/4", 3/8" & 1/2" body length), Shim Post Holder, 7 Spacer Shims (3 each: 1/64", 2 each: 1/32" & 1/16"), Metal Kit Box

Part Number	Description
53-26F	31 PC Flush Set Kit

Dimple Die Kit Includes:

4 Dimple Punches (1/4" body length: 3/32", 1/8", 5/32" & 3/16"), 4 Dimple Dies (1/4" body length: 3/32", 1/8", 5/32" & 3/16"), Plastic Kit Box

Part Number	Description
53-3456	9 PC Dimple Die Kit

RIVET SQUEEZERS & ACCESSORIES

AN426 100° Dimple Punch & Dies

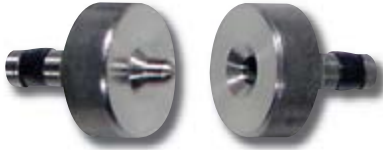

.187" Shank Punch & Die		
Part No. Punch	Part No. Die	Body Length
26-P211	26-D211	1/4"
26-P212	26-D212	3/8"
26-P213	26-D213	1/2"

.250" Shank Punch & Die		
Part No. Punch	Part No. Die	Body Length
26-P231	26-D231	1/4"
26-P232	26-D232	3/8"
26-P233	26-D233	1/2"

.312" Shank Punch & Die		
Part No. Punch	Part No. Die	Body Length
26-P251	26-D251	1/4"
26-P252	26-D252	3/8"
26-P253	26-D253	1/2"

.187" Shank Punch & Die Combos	
Part Number	Body Length
53-211	1/4"
53-212	3/8"
53-213	1/2"

.187" Shank Combo Set (3/32", 1/8", 5/32" & 3/16")	
Part Number	Body Length
53-3456	1/4"

Note: Select a size punch, die or combo (charts above) & add the rivet size (chart below).
Example: For .187" shank, 1/4" body punch with a 1/8" rivet size, use part no. 26-P211-4264.

Countersunk AN426 Cupping Sizes					
1/16"	3/32"	1/8"	5/32"	3/16"	1/4"
4262	4263	4264	4265	4266	4268

Dimple Punch & Dies For 100° Screws



.187" Shank	
Part Number	Screw Size
53-5094	#6
53-5095	#8
53-5096	#10

.187" Shank	
Part Number	Screw Size
53-5098	1/4"
53-50910	5/16"

'Spring Back' Dimple Die Sets

Form Perfect
100° Dimples



.187" Shank	
Part Number	Rivet Size
4263PDSB	3/32"
4264PDSB	1/8"
4265PDSB	5/32"

.187" Shank	
Part Number	Rivet Size
5094PDSB	#6
5095PDSB	#8
5096PDSB	#10

Cherry® Hollow End E-Z Buck Dies

NEW

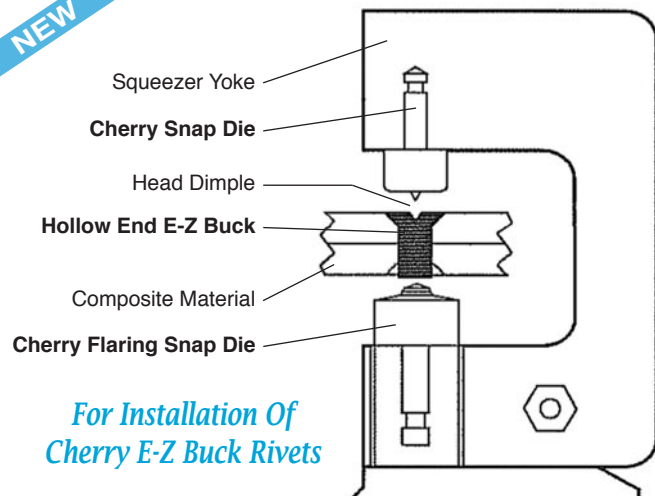

For Installation Of
Cherry E-Z Buck Rivets

These dies should be used with automatic riveting machines or by a squeezer of sufficient size to provide the upset loads listed below. The snap dies are designed to center the squeezer on the rivet and prevent damage to the structure.

Acceptable Upset Loads	
Rivet Diameter	Upset Load +/- 200 lbs
1/8" (-4)	2500 lbs (1134 kgs)
5/32" (-5)	2700 lbs (1225 kgs)
3/16" (-6)	3000 lbs (1361 kgs)
7/32" (-7)	3750 lbs (1701 kgs)

Cherry Flaring Snap Dies		
3/16" Mount Dia.	1/4" Mount Dia.	Rivet Diameter
839B1-4	839B10-4	1/8" (-4)
839B1-5	839B10-5	5/32" (-5)
839B1-6	839B10-6	3/16" (-6)
839B1-7	839B10-7	7/32" (-7)

Cherry Snap Dies		
3/16" Mount Dia.	1/4" Mount Dia.	Rivet Diameter
839B3	839B13	All Sizes