

Series 1

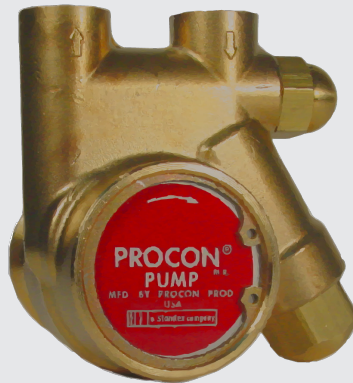

Features and Benefits

- 140 GPH (425 LPH)* at 200 PSI (14 bar)
- Internal Relief Valve set at 250 PSI
- Horsepower required 0.52 hp (387)
- Self priming (water) and maintenance free with low vibration and pulsation characteristics
- Works with fluid with viscosity up to 100 centipoise (cP), temperature between -4°F to 194°F (-20°C to 90°C)¹
- Brass housing works with TDS max 5,000
- Clockwise rotation
- Integral strainer of 3.25 sq. in. for debris removal

General Applications

Cold Carb Circulation

*GPH rating at 1725 RPM/60Hz and LPH rating at 1450 RPM/50Hz

Technical Information

Pump Housing Material	Low Lead Brass (0.2% max)		
Seals	Carbon / Ceramic		
Elastomers	Ethylene Propylene (EPDM)		
Valves	Plastic (high temp ultem)		
Drive configurations	Double flat		
Vanes	Carbon	Mounting Options	Clamp-on
Ports	NPT 3/8"	Unit Weight	Approx. 2.5 lbs. (1.1kg)

Operating Range

Fluid Temperature	-4° to 194°F (-20° to 90°C)	Speed	1750 at 60 Hz (1450 at 50 Hz)
Viscosity	100 cP	Wet Lift with Water	6 ft (2M)
Max Discharge Pressure	250 PSI (17 BAR)		

161A140W11AA 250 Nominal Volume*										
Flow rate (GPH/ LPH)	Gallons Per Hour/Liters Per Hour					Brake Horsepower/Watts (motor shaft power)				
	Pressure (PSI/Bar)					Pressure (PSI/Bar)				
	50/3.4	100/6.9	150/10.3	200/13.8	250/17.5	50/3.4	100/6.9	150/10.3	200/13.8	250/17.5
140/425	143/447	141/441	139/434	137/428	135/422	0.17/127	0.28/209	0.40/298	0.52/387	0.63/469

RoHS

WRAS

ISO
9001:2015

¹ Consult with manufacturer for extreme operating conditions

² Consult with manufacturer for information on other applications

³ For certificate of compliance or declarations please visit our website or email at productcompliance@proconpump.com

* GPH rating at 1725 RPM/60Hz and LPH rating at 1450 RPM/50Hz

161A140W11AA 250 ROTARY VANE PUMP DIMENSIONS

Clamp-On Mounting

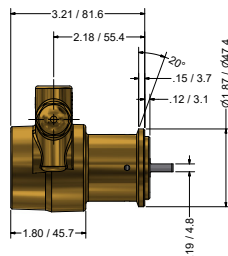
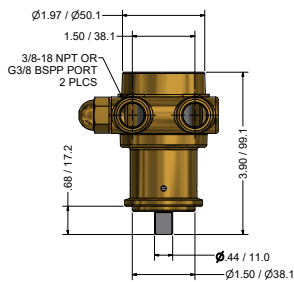

With Strainer

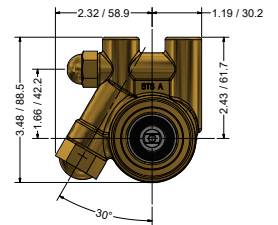

NOTE:

- All dimensions are in inches/millimeters
- Bronze and plastic coupling available for clamp-on

Tennessee, USA
869 Seven Oaks Blvd.
Suite 120
Smyrna, TN 37167
001.615.355.8000
sales@proconpump.com

Mountmellick, Ireland
Irishtown, Mountmellick, CO.
Laois, Republic of Ireland
00353.57.86.24350
sales@standex.ie

Tianjin, China
J3A101, Western Area
Xuefu Huigu Industrial Park
Tianjin, China 300402
00.86.22.86996885