

STF series Heavy Duty Stopper Cylinder (Flange & Lock mechanism)

Product features

CHELIC

Internal structure

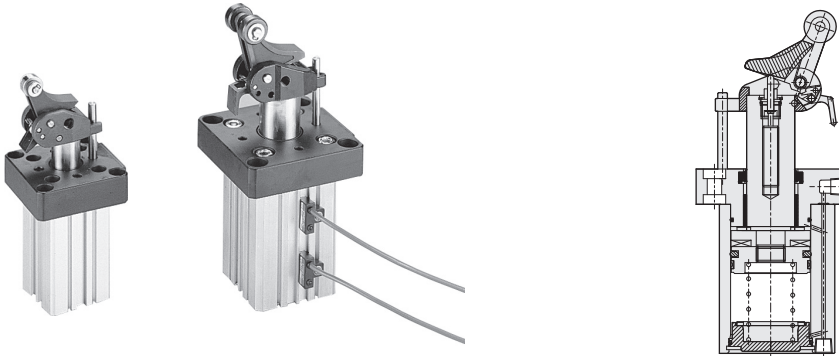

Specification

Item	Bore size (mm)	Ø32	Ø50
Action		Double/ Single acting	
Fluid		Air	
Pressure range	Kgf/cm ² (kPa)	1 ~ 8.5 (100 ~ 850)	
Ambient and fluid temperature	°C	0 ~ 60	
Piston speed	mm/s	50 ~ 700	
Standard stroke	mm	20	30
Lubrication		Lubrication free type	
Port size		Rc 1/8	
Sensing device		With magnet	

Code of order

STF – **32** × **20** – **D** – **SE 2** – **H**

Model Bore size Stroke Operation type Sensor switch Cushion force

STF:
Stopper cylinder

Select table of cushion force (STF - Ø50)

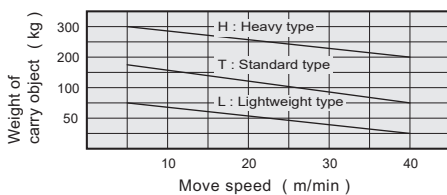

[D]: Double acting

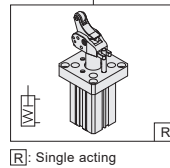

[SE]: Sensor switch code (CS-30E)
[2]: Number of sensor switch
1 = 1 PCS
2 = 2 PCS

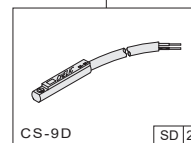

[H]: Heavy type
[T]: Standard type
[L]: Lightweight type

STF series Heavy Duty Stopper Cylinder (Flange & Lock mechanism)

Product features

CHELIC

Internal structure

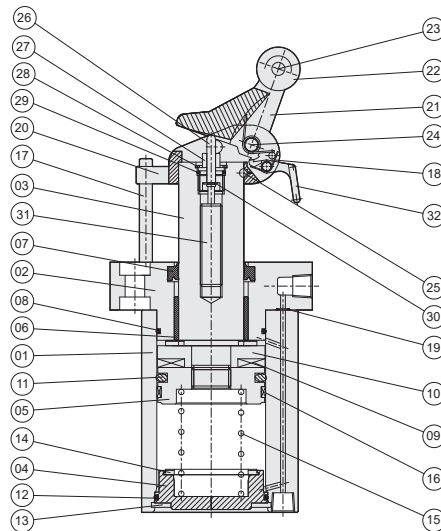

STB

STC

STD

STDL

STF

Components and material list

No.	Item	Material	No.	Item	Material
01	Body	Aluminum alloy	18	Spring	Spring steel
02	Flange	Aluminum alloy	19	O-ring	NBR
03	Shaft	Carbon steel	20	Mounting base	Alloy steel
04	Rear cover	Aluminum alloy	21	Rocking arm	Alloy steel
05	Piston	Copper Alloy	22	Roller lever	Carbon steel
06	Bearing	Teflon	23	Dowel pin	Bearing steel
07	Shaft packing	NBR	24	Dowel pin	Bearing steel
08	O-ring	NBR	25	Dowel pin	Bearing steel
09	Magnet	Magnet	26	Air cushioning lever	Carbon steel
10	Magnet base	Aluminum alloy	27	Air cushioning base	Copper Alloy
11	Piston packing	NBR	28	Clip	Steel spring
12	O-ring	NBR	29	O-ring	NBR
13	Rear cap clip	Spring steel	30	E clip	Steel spring
14	Cushion gasket	Rubber	31	Shock absorber	Carbon steel
15	Spring	Spring steel	32	Positioning plate	Alloy steel
16	Wear ring	Plastic steel	33		
17	Dowel rod	Carbon steel	34		

Packing and O-ring material list

Item	Shaft packing	Front cover O-ring	Piston packing	Rear cover O-ring	Mounting base O-ring
Bore size	Quantity	1	1	1	1
Ø32	DRP-20	Ø28.5 x Ø2	COP-32	Ø32 x Ø2	Ø6 x Ø1.5
Ø50	DRP-30	Ø47.5 x Ø2	COP-50	Ø48 x Ø2	Ø6 x Ø1.5

STF series Heavy Duty Stopper Cylinder (Flange & Lock mechanism)

Instructions

CHELIC

Application

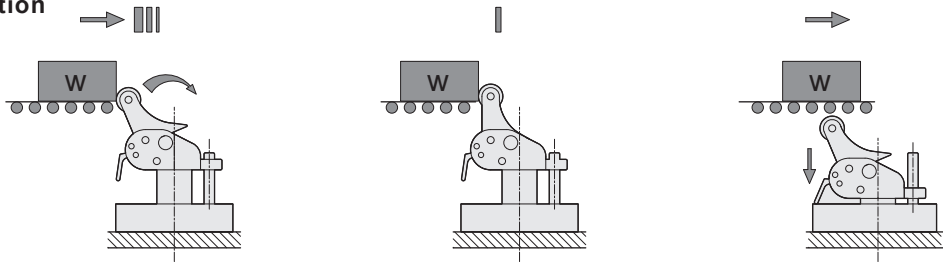

① Conveyor brings the product to the stopper Cylinder.

② Stop the pallet (Position the pallet)

③ Stopper then moves under the conveyor, this clears the obstruction and the product starts to move again.

Attachment

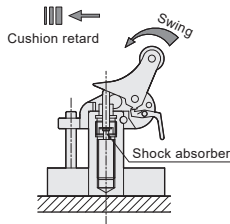

● Stops the product creating a cushioning effect, thereby reducing shock and vibration.

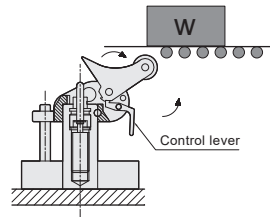

● Optional-disables stopper cylinder function Capnut 45 causes leer to not move. This creates a non-shop conveyor.

Mounting type

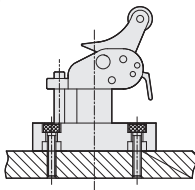

● Top mounting

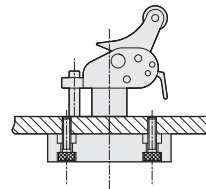

● Bottom mounting

Strike force allowable

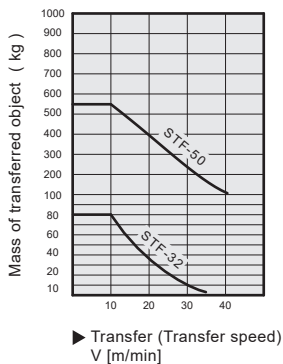

Normal horizontal load

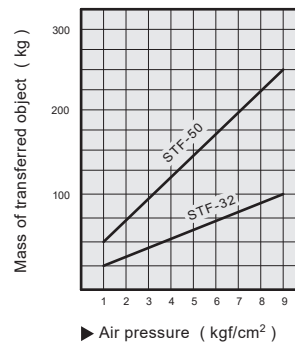

STF series Heavy Duty Stopper Cylinder (Flange & Lock mechanism)

Dimensions

CHELIC

STF 32 x

 STF 32 x ST

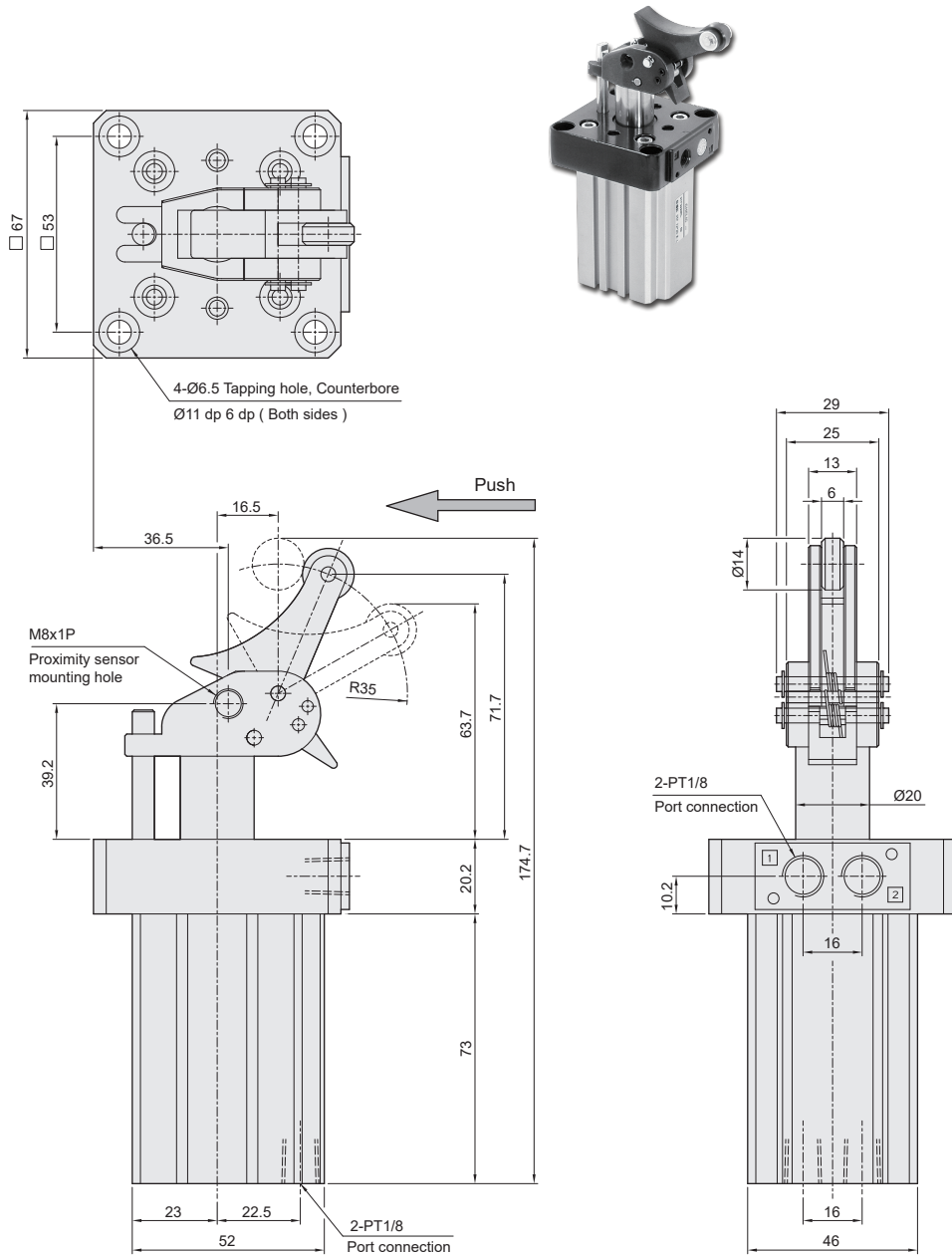

STB

STC

STD

STDL

STF

STF series Heavy Duty Stopper Cylinder (Flange & Lock mechanism)

Dimensions

CHELIC

STF 50 x

 STF 50 x ST

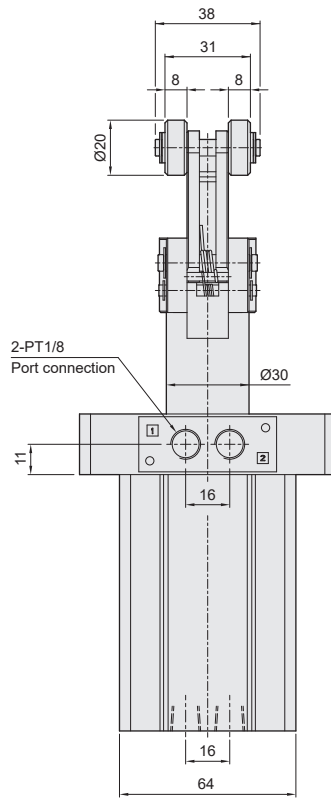
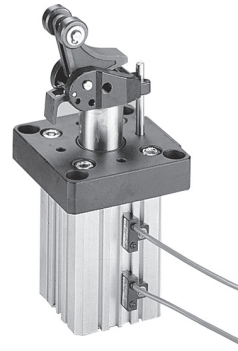
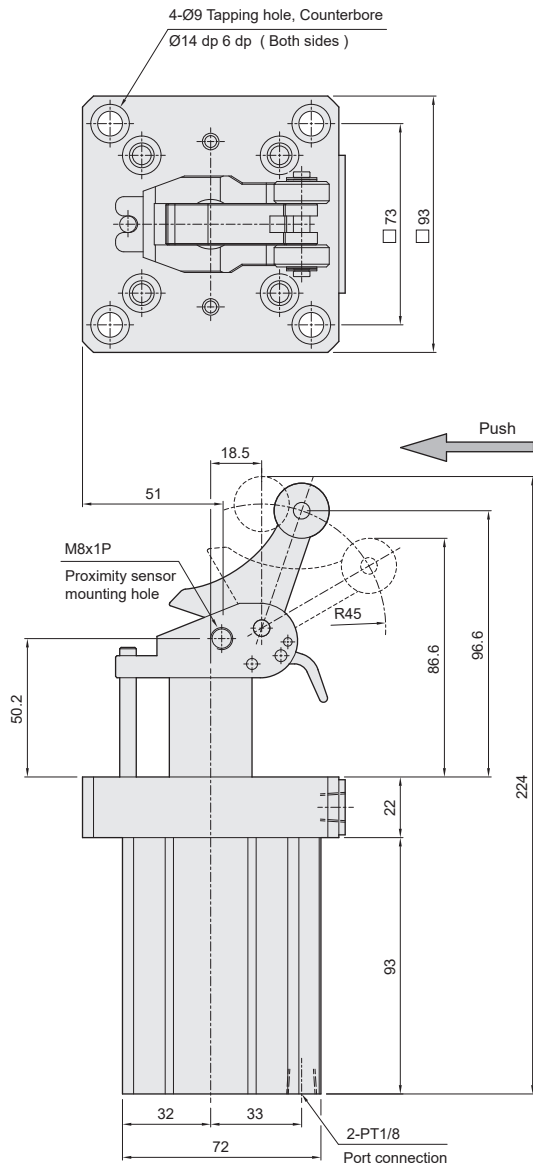

STF(C, D, F) series Heavy Duty Stopper Cylinder (Flange & Lock mechanism)

Sensor switch operating range and the setting

CHELIC

Sensor switch mounting type

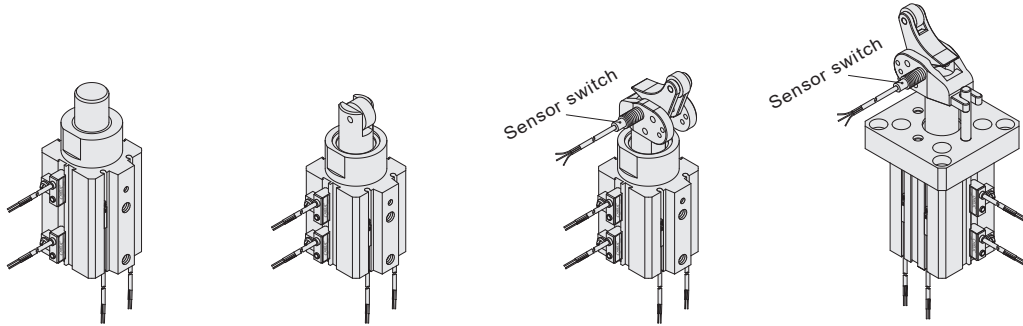

STB

STC

STD

STDL

STF

Sensor switch setting and operating range

CS-30E

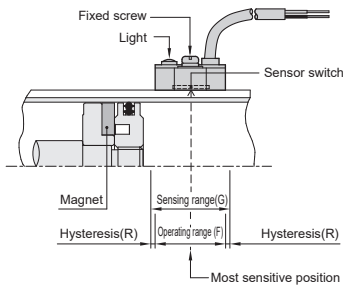

CS-9D(B)

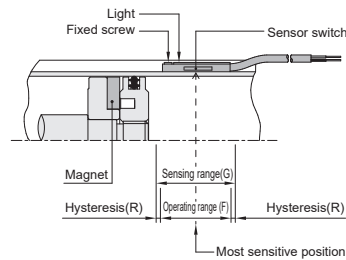

Sensing range

Sensor switch is fixed on the cylinder body. The magnetic piston head will activate the Sensor switch when it enters the operating range. It has 0.5mm differential.

Operating range

When piston head moves the switch setting and adjustment will be based on the responding range generated by the magnetic field and the switch. (Please refer to the below table)

Unit: mm

Model	CS-30E		CS-9D(B)	
Bore size	Operating range (F)	Hysteresis(R)	Operating range (F)	Hysteresis(R)
Ø32	8.5	1	7	1
Ø40	11	1	8	1
Ø50	11	1.2	9	1.2

Sensor switch introduction

