

MGA / MGS series

2/2 WAY N.C. PISTON TYPE SOLENOID VALVE

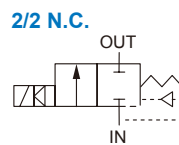

Specification

- Forged brass body.
- IP65 100% ED coil.
- PTB approval EExm II T4 coil.

Power consumption

Coil power	4	5	3E
AC (VA)	17.6/15.4	33/23	9.2
DC (W)	15.0	18.5	10

Model	MGA / MGS	
Code	10	15
N.W (kg)	0.6	

Order example

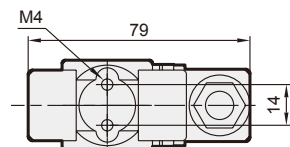
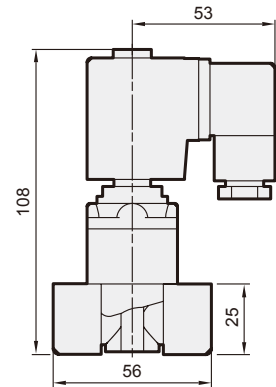
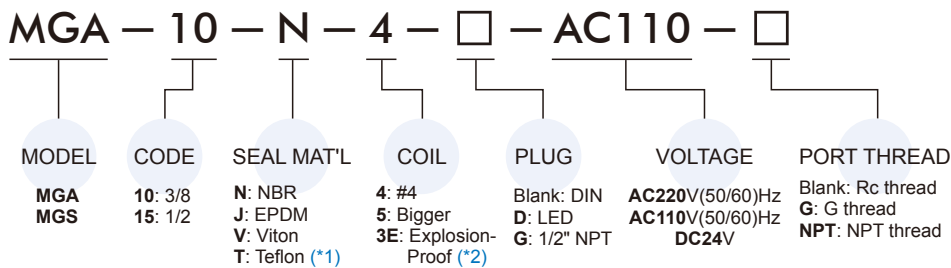

*1. When the seal material is (T) Teflon, the valve has slight leakage.
*2. Explosion-Proof (3E) coil with LED (D) plug is not applicable.

Specification

Model MGA : for water, air and higher temp. fluids. 2/2 way N.C.															
Code (Port)	Seal mat'l	Coil	Orifice mm	Temp. 5~°C						Working press. bar					CV
				Coil 4			Coil 5, 3E			Coil 4		Coil 5		Coil 3E	
				N	J	V	N	J	V	AC	DC	AC	DC	AC/DC	
10(3/8)	N,J,V	4,5,3E	12	95	120		95	145		0.3~10	0.3~7	0.3~16	0.3~10	0.3~5	1.9
15(1/2)				2.6											

Model MGS : for steam and higher temp. fluids. 2/2 way N.C.										
Code (Port)	Seal mat'l	Coil	Orifice mm	Temp. 5~°C				Working press. bar		CV
				Coil 4		Coil 5		Coil 4	Coil 5	
10(3/8)	T*	4, 5	12	158		185		0.3~5	0.3~10	1.9
15(1/2)				2.6						

* Teflon seal will have 400cc/min. down gas leakage.