

# APE1F-5M-10-2-Z

## Subminiature Pushbutton Switches

Washable

RoHS Compliant

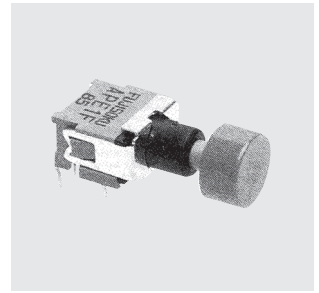

### Features

1. Twin-contact clip mechanism for high reliability.
2. Process sealed structure
3. Gold-plated contacts.
4. Terminal pin pitch: 2.54 mm.

### Specifications

Rating	Max:100mA 48VAC/DC Min:1μA 20mVAC/DC 0.4VA (Voltage range 20mV~28V) (Current range 1μA~20mA)
Initial contact resistance	50mΩ max. (1.5mA 200μVAC)
Dielectric strength	500VAC 1 minute
Insulation resistance	500MΩ min. (500VDC)
Electrical life	10,000 operations at maximum rating. 50,000 operations at min. rating or 0.4VA
Operating force	0.78~2.94N
Operating temperature range	-20~+85°C
Storage temperature range	-40~+85°C

### Optional Accessories

《Sold separately》

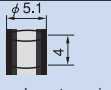
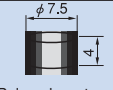
Part name	Color Button	
Dimensions	 Polycarbonate resin	 Polycarbonate resin
White	140000481572	140000481528
Red	140000481571	140000481529
Black	140000481495	140000481499

### Color Button Mounting

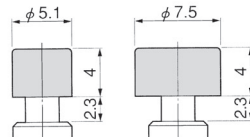

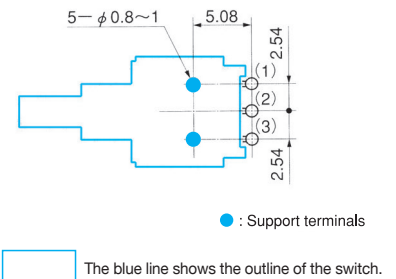

### PC Hole Layouts

《Top view》

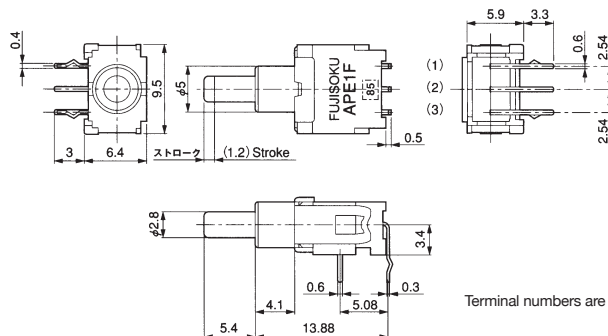

### SPDT



Switching function		Push 
Part No.	ON	(ON)
Connecting terminals	2-3	2-1

Terminal numbers are not shown on the switch.

PC